

PARCEL IDENTIFICATION NUMBER (PIN)

MARSHALL COUNTY, IOWA

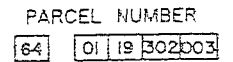

MARSHALL COUNTY

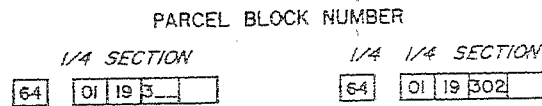
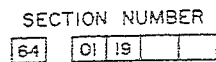
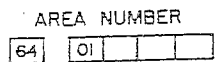
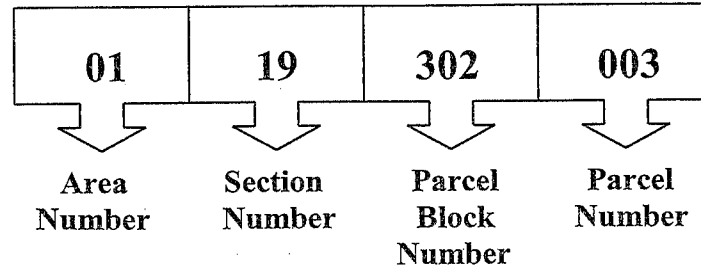
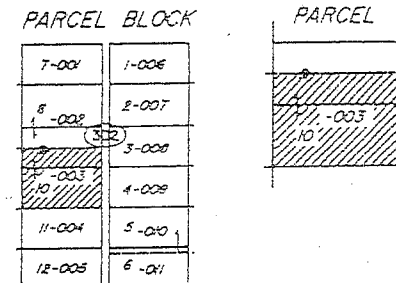
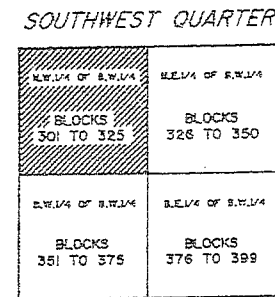
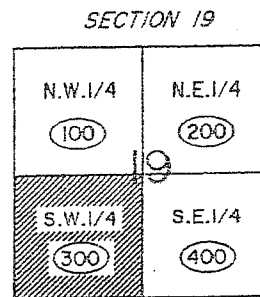
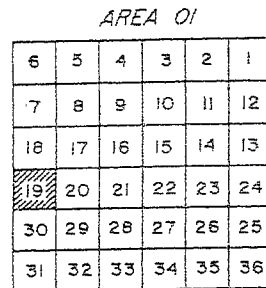
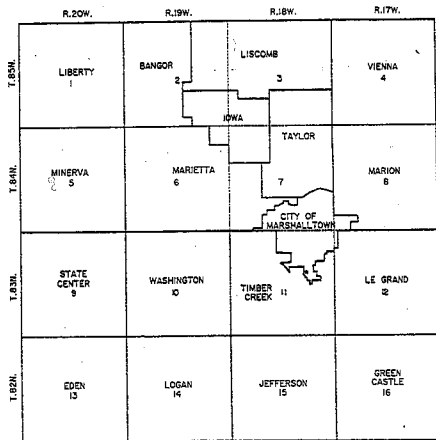

A SECTION OF LAND — 640 ACRES

Chains Rods Feet
Quarter Sections and Subdivisions Thereof

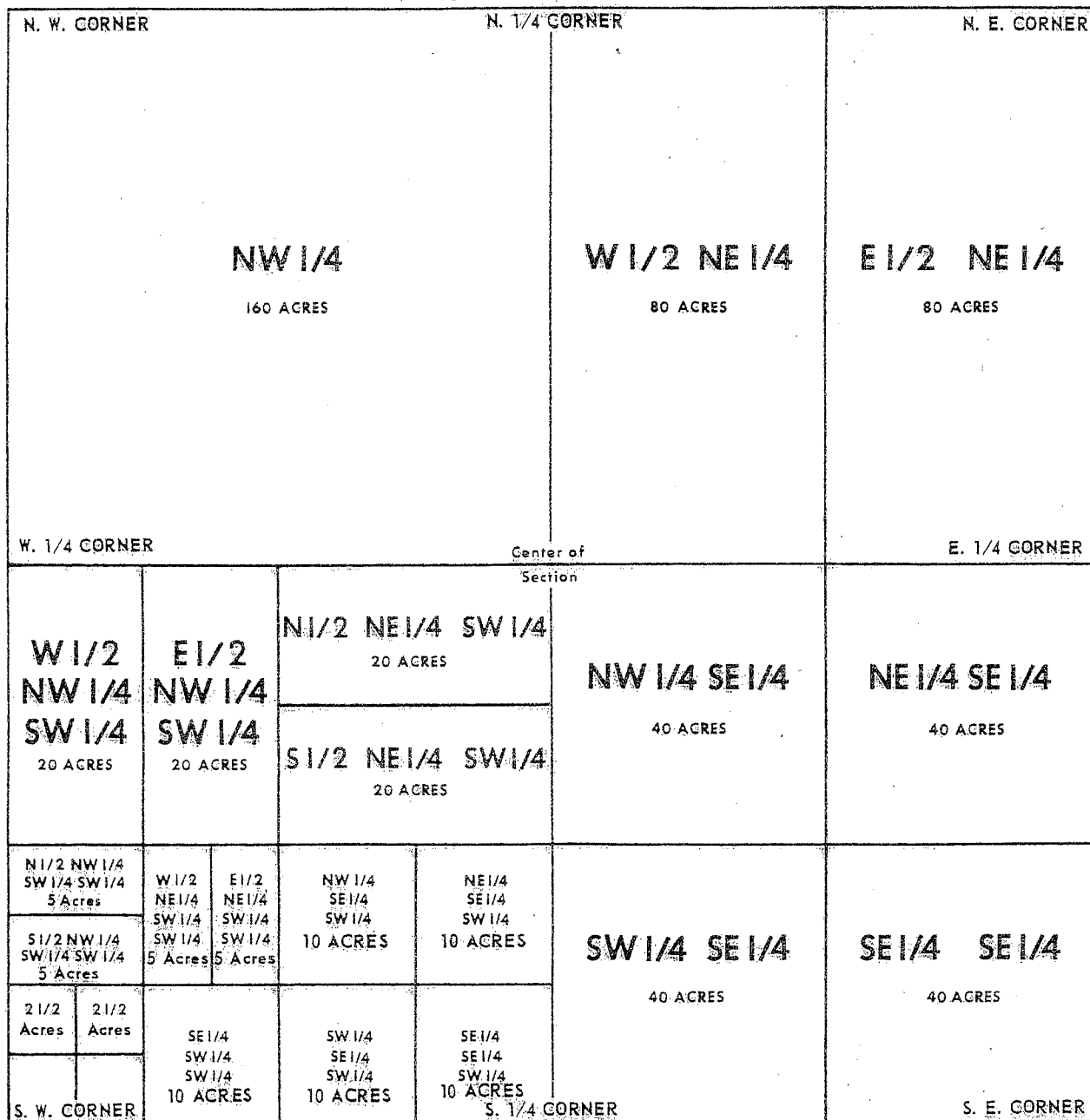

	1/4 Mile	1/2 Mile	3/4 Mile	1 Mile
Chains	20	40	60	80
Links	2,000	4,000	6,000	8,000
Rods	80	160	240	320
Feet	1,320	2,640	3,960	5,280

A rod is 16 1/2 feet
 A chain is 66 feet or 4 rods
 A link is 1/100 of a chain or 7.92 inches
 A mile is 320 rods, 80 chains or 5,280 feet

A square rod is 272 1/4 square feet
 An acre contains 43,560 square feet
 An acre contains 160 square rods
 An acre is about 208 3/4 feet square
 An acre is 8 rods wide by 20 rods long — or any two numbers (of rods) whose product is 160.

To reduce square feet to acres .000023 is the reciprocal of 43,560 square feet. Multiply the number of square feet by .000023, or multiply by 23 and count off six places.